

**CERTIFIED LAND CORNER RECORDATION**

DESCRIPTION OF CORNER EVIDENCE FOUND, AND ORIGINAL RECORD (if known)

Found 18" X 14" X 12" gray stone at north side of fence corner post with 1/2" rebar at north face.

DESCRIPTION OF MONUMENT AND ACCESSORIES ESTABLISHED TO PERPETUATE THE ORIGINAL LOCATION OF THIS CORNER:

See sketch below.

SKETCH, WITH COURSE AND DISTANCE TO ADJACENT CORNER IF DETERMINED IN THIS SURVEY.  
(May Sketch or Paste Reproduction on Reverse Side.)

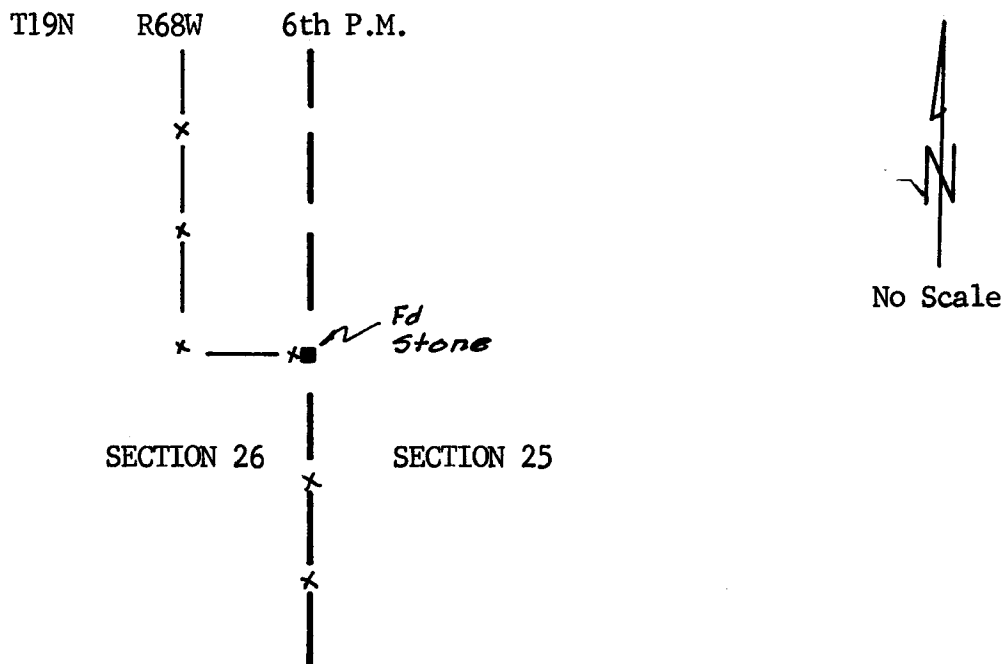

I, Albert L. Scott certify that I have carefully performed or reviewed the work done on the diagrammed corner as reported on this recordation form and approve the same.

  
 Signature of Surveyor L.S. 2573  
Registration No.

STATE OF WYOMING,  
Office of Clerk and Recorder,  
County of \_\_\_\_\_

**567569**

This "corner record" was filed for record on the \_\_\_\_\_ day of FEB 12 1980, 19\_\_\_\_, was noted on the cross-index plat and is assigned page No. \_\_\_\_\_, in book No. \_\_\_\_\_.

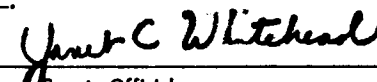
  
 County Official 6th P.M.

Cross Index No.	<u>T21</u>	T. <u>19N</u>	R. <u>68W</u>	Mer.
		T. _____	R. _____	Mer.
		T. _____	R. _____	Mer.
		T. _____	R. _____	Mer.
		T. _____	R. _____	Mer.
		T. _____	R. _____	Mer.
		T. _____	R. _____	Mer.